

*Franklin Township Public School District*

Merit Goal Report 2019-2020

**Dr. John A. Ravally**

**Quantitative Goal #1:** *Directly Connected to Board Goal #1*

By June 30 2020, 52% (3.33% Compensation); 49% (2.33% Compensation); 47% (1.33% Compensation) of grade 8 students will meet their iReady typical growth target in mathematics set after the “beginning year” iReady diagnostic in mathematics. Student achievement will be positively impacted through intensive staff development on the use of iReady to supplement the district’s core mathematics program and an increase in iReady usage as an intervention tool at the middle school level. (Baseline 45%)

<b>Grade 8 Subject</b>	<b>Students Meeting Typical Growth</b>	<b>Students Tested</b>	<b>% Increase</b>
Mathematics	220	459	48%

Strategies to increase achievement:

- Professional Development for staff on how to connect iReady to core program
- Increase time dedicated to utilizing iReady
- Create incentives for encouraging iReady usage

Approved as a Quantitative Goal met at the 1.33% level

**Quantitative Goal #2:** *Directly Connected to Board Goal #1*

By June 30 2020, 60% (3.33% Compensation); 57% (2.33% Compensation); 55% (1.33% Compensation) of grade 8 students will meet their iReady typical growth target in reading set after the “beginning year” iReady diagnostic in reading. Student achievement will be positively impacted through intensive staff development on the use of iReady to supplement the district’s core literacy program and an increase in iReady usage as an intervention tool at the middle school level. (Baseline 53%)

<b>Grade 8 Subject</b>	<b>Students Meeting Typical Growth</b>	<b>Students Tested</b>	<b>% Increase</b>
Language Arts	258	453	57%

Strategies to increase achievement:

- Professional Development for staff on how to connect iReady to core program
- Increase time dedicated to utilizing iReady in school
- Create incentives for encouraging iReady student usage at home

Approved as a Quantitative Goal met at 2.33% level

### **Quantitative Goal #3: Directly Connected to Board Goal #2**

**By June 30 2020, a 3 – year old preschool program will be established and enrollment of the 3 year old preschool program will be 30 students (3.33% compensation); 20 students (2.33% compensation); 10 students (1.33% compensation) for the 2020-2021 school year. The Superintendent will ensure the recruitment of properly certified teachers to teach in the 3 - year old Pre-K program, will guide the development of an age appropriate curriculum for the 3-year old Pre-K program, and will ensure appropriate and compliant classroom space is available to house the 3-year old Pre-K Program.**

Number of Teachers	Number of Sections	Total Enrollment
*4	4	24

Current Pre-K 3 Program Locations:  
2 at Hillcrest School  
1 at Franklin Park School  
1 in the Early Childhood Room at FHS

NJ DOE Approved Pre-K3 Program – [The High Scope Curriculum](#)

*\*Program Teachers hired at the May 28, 2020 Board of Education Meeting*

**Approved as a Quantitative Goal met at 2.33%**

**Qualitative Goal #1:** *Directly Related to Board Goals #3 & 4*

**By June 30 2020, the Superintendent will work with key community stakeholders to design and develop architectural plans for the four (2.5% compensation), two (1.25% compensation) remaining undeveloped community spaces located in Community Center on the newly acquired Board of Education Campus located at 2301 NJ- Rt 27, Someset, NJ. The design of the rooms will be aligned with the district's mission and goals while meeting the needs of the larger community.**

Board and Township Townhall held October 28, 2019

Survey Instrument used to gain further community input closed  
December 2019

Board of Education reviewed Community Input and toured BAC Community Center with SSP Architectural Firm Early Winter 2020 to review suggested floor plan and designs after input of Community

SSP Met with Township to discuss draft plan

SSP Finalized plan and phased plan to meet budget constraints Spring 2020

Approved as a Qualitative Goal Met at 2.5% level

# Community Center Plan

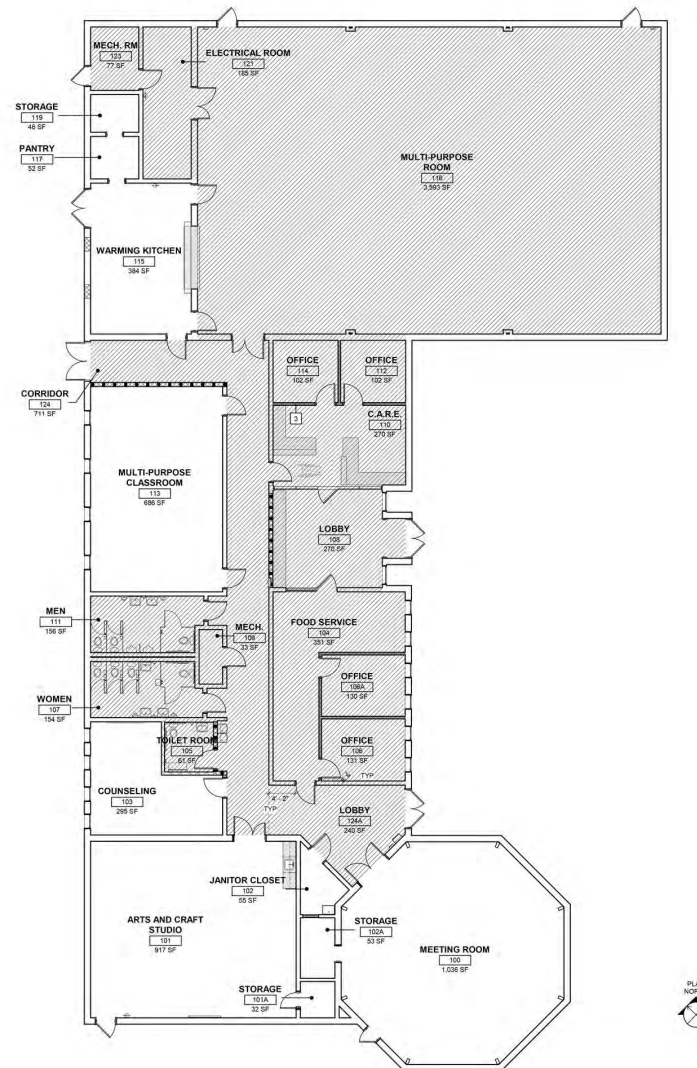



# Room 113



# Small Counseling Room





# Work/Craft Space

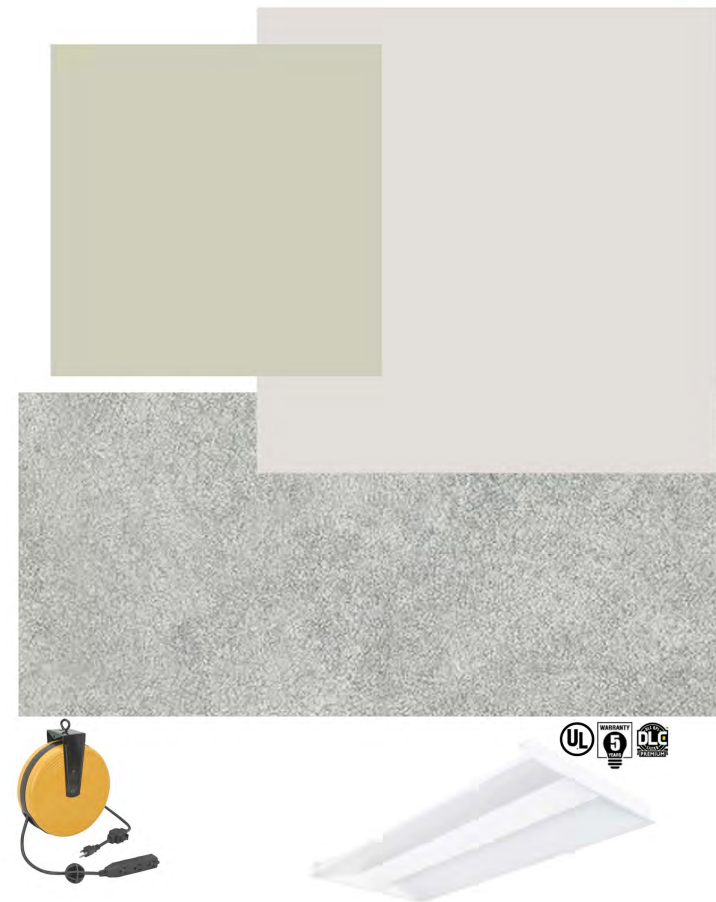
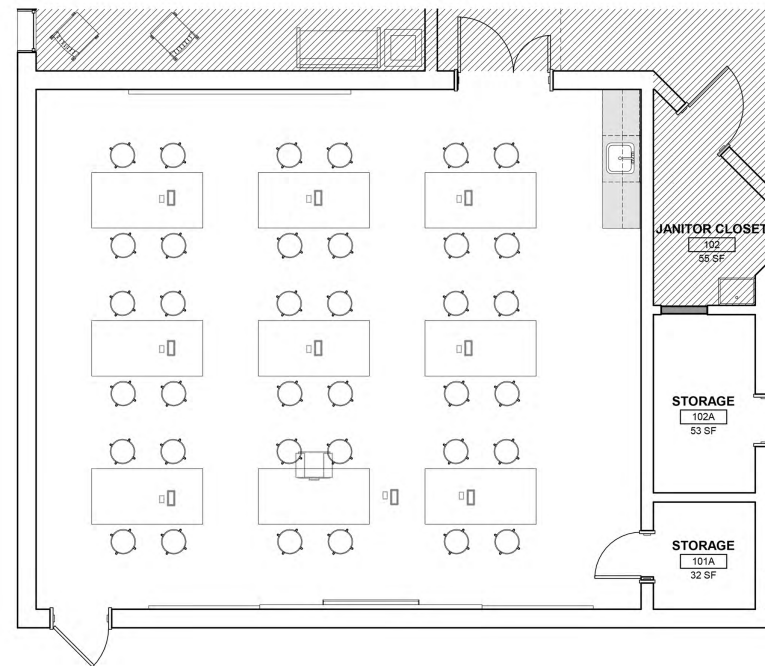

# Work/Craft Space





# Presentation Room

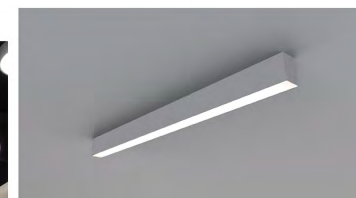
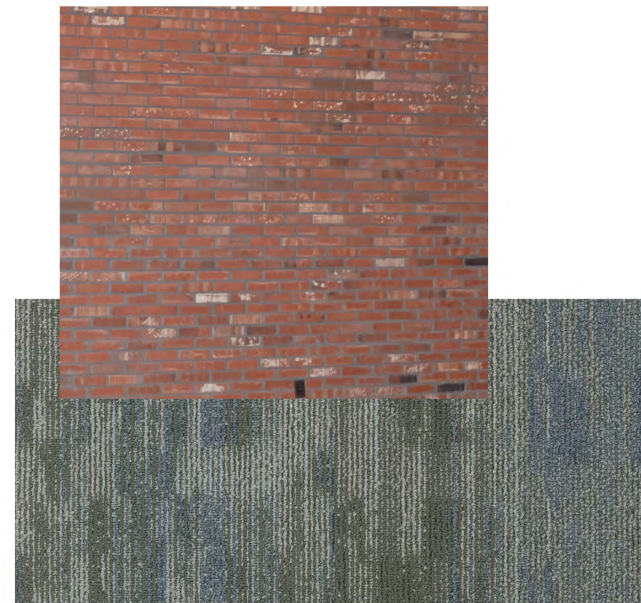
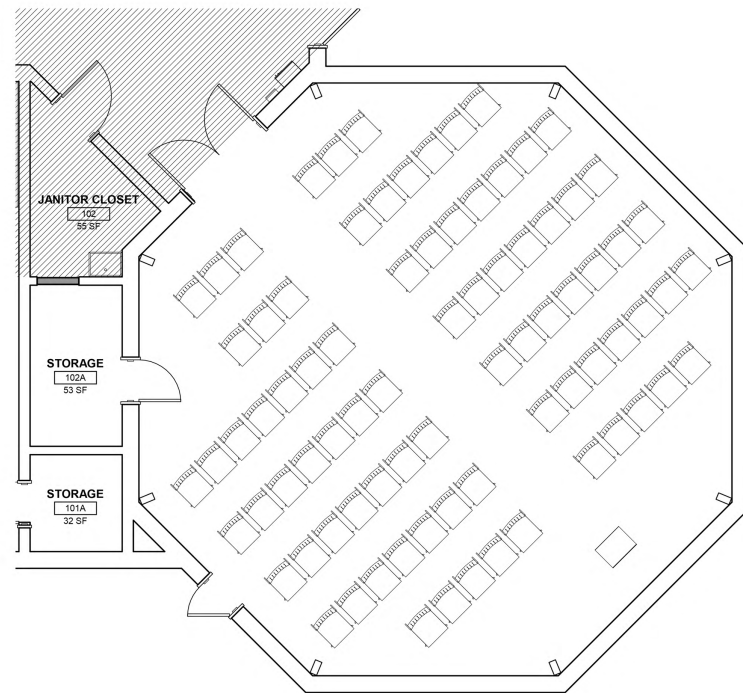

# Presentation Room





**Qualitative Goal #2: *Directly Related to Board Goal #4***

**By June 30, 2020, the Superintendent will work with district staff to design and develop a district-wide early childhood development handbook to help inform parents about the Franklin School District Early Childhood Education Program and in addition the Superintendent will survey parents and research best practices to help design an orientation program that supports families as they transition their children into the Franklin Township Early Childhood Program of Studies**

Met with Early Childhood Supervisor & Director of PPS late Fall 2019 reviewed current handbook and discussed plan of action for revising

Work interrupted by Pandemic

Qualitative Goal Not Met

# Other Major Board Accomplishments

- Established the District Core Equity Team
- Created and approved the first read of a District Anti-racism Policy
- Successfully completed and passed NJQSAC Review
- Completed Middle School Security Camera Upgrades
- Established the first ever FHS Aviation Club

# Major Accomplishments Continued

- Adopted Interactive the Middlebury World Language Program to support K-8 World Language Teachers and Program
- Earned District-wide Future Ready Status
- Earned Bronze Level Sustainable NJ Recognition at MacAfee School & Hamilton Street Campus
- Established the J&J Bridge to Employment Program at FHS

# APPENDICES

- *Appendix A* – Support Document from Office of Data Management for Goal #1
- *Appendix B* – Support Document from Office of Data Management for Goal #2
- *Appendix C* – Support Document from Pupil Personnel Services for Goal #3



# Appendix A

## Diagnostic Growth



School  
Subject  
Academic Year  
Comparison Diagnostic  
Placement Definition

All Schools  
Math  
2019 - 2020  
Most Recent  
End-of-Year View

Students Assessed/Total: 3,777/3,907

Progress to Annual Typical Growth (Median)

[Learn more about growth](#)

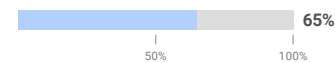

The median percent progress towards Typical Growth for this school is 65%. Typical growth is the average annual growth for a student at their grade and placement level.

Distribution of Progress to Annual Typical Growth

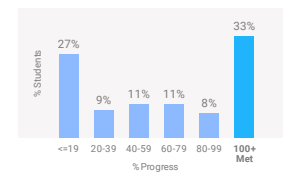

Distribution of Progress to Annual Stretch Growth

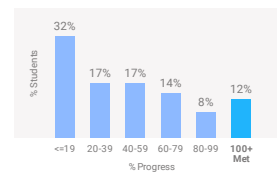

Current Placement Distribution

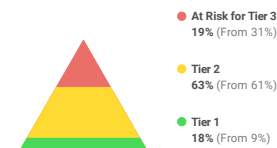

Show Results By

Grade

Showing 1 of 8

8	Annual Typical Growth		Annual Stretch Growth		% Students with Improved Placement	Students Assessed/Total
	Progress (Median)	% Met	Progress (Median)	% Met		
Grade 8	83%	48%	36%	19%	42%	459/495

# Appendix B

## Diagnostic Growth



School  
Subject  
Academic Year  
Comparison Diagnostic  
Placement Definition

All Schools  
Reading  
2019 - 2020  
Most Recent  
End-of-Year View

Students Assessed/Total: 3,746/3,906

Progress to Annual Typical Growth (Median)

[Learn more about growth](#)

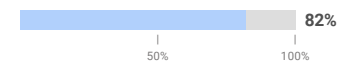

The median percent progress towards Typical Growth for this school is 82%. Typical growth is the average annual growth for a student at their grade and placement level.

Distribution of Progress to Annual Typical Growth

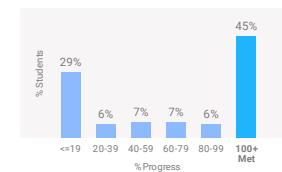

Distribution of Progress to Annual Stretch Growth

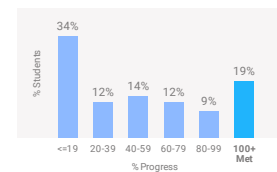

Current Placement Distribution

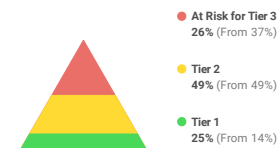

Show Results By

Grade

Showing 1 of 8

8	Annual Typical Growth		Annual Stretch Growth		% Students with Improved Placement	Students Assessed/Total
	Progress (Median)	% Met	Progress (Median)	% Met		
Grade 8	125%	57%	41%	25%	51%	453/495

# Appendix C

From: "Sofield, Dr. Brenda" <btirabassisofield@franklinboe.org>  
Subject: Preschool 3 Enrollment numbers  
Date: August 7, 2020 at 10:25:21 AM EDT  
To: "Dr. John Ravally" <jravally@franklinboe.org>

Good Morning,

I would like to update you on the enrollment information for the district's three-year-old preschool initiative.

During the January 2020 pre-registration period, 125 families expressed interest in participating in PreK 3. 24 students completed the enrollment process prior to the emergency closure.

Four classrooms have been identified for the Prek 3 classrooms in the following buildings:  
Hillcrest Elementary School (2)  
Franklin High School (1)  
Franklin Park School (1)

These classrooms comply with State preschool requirements.

Please let me know if you have any questions.

Dr. Brenda Sofield, MSED, MA, LDT-C

Director of Pupil Personnel Services  
Franklin Township School District  
1755 Amwell Road  
Somerset, NJ 08873  
(732) 873-2400 x216

*Never Underestimate Your Ability to Change the World.*

<https://www.state.nj.us/education/specialed/form/prise/>